

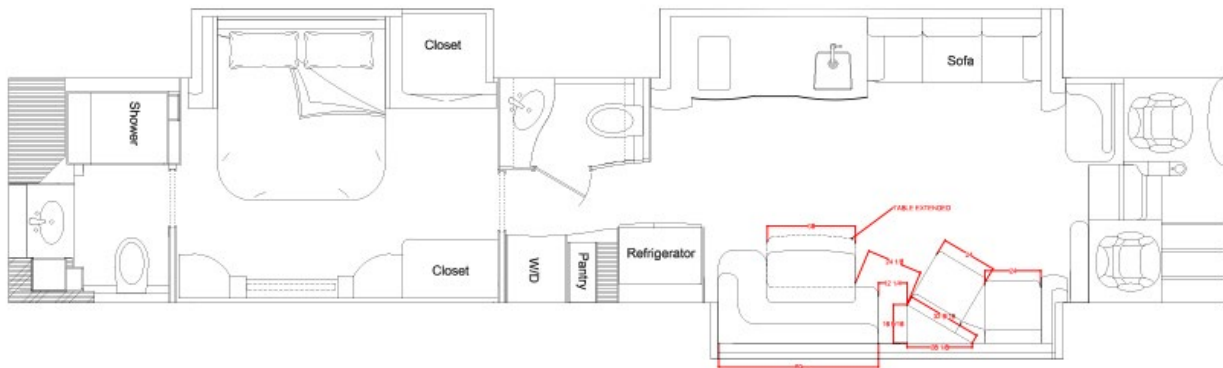

2021 Millennium H3-45
 Triple Slide, Bath & a Half
 Stock # 1025





COACH SPECIFIC DETAILS

SALON

- Electric Jack-knife sofa design
- Custom leather chase recliner
- Custom designed ceiling with easily cleaned leatherette, mahogany rails, textured inlay, mirrors and directional roof air venting
- Window and wall treatments custom designed to enhance beauty of interior while giving occupant maximum exposure to view from windows
- Custom decorative throw pillows
- Lutron Silent Power Cell Shades throughout coach which can be operated individually or all together with Savant I-Pad

GALLEY

- J-Lounge design with custom cabinets above lounge
- Natural wood veneer with high grade marine polyurethane (no seams, cannot delaminate) and limited lifetime warranty
- Elegant multi-level cabinetry with curved radius exposures for maximized visual appeal
- Lightweight counter and tabletops with indirect LED lighting
- Sink constructed out of countertop stone
- Roll out shelving in large pantry with automatic locking system
- Custom tile back splash
- Concealed paper towel holder
- Fisher & Paykel dishwasher
- Convection microwave in cabinetry with slide back doors for easy access
- Side by side refrigerator with ice & water in door
- Two burner electric cook top
- All cabinet doors and drawers have positive catches
- Interior of cabinets securely finished with plush liner
- Single handle faucet with built-in sprayer
- Porcelain tile flooring in salon and galley
- Air operated doors with build-in safety disconnect
- LED accent lighting in all side windows

BATH/SHOWER

- Bath & ½ layout
- Water-jet macerating anti-fume toilet
- Fantastic vent fan with rain sensor in lavatory
- Built-in bidet, cleaner, dryer with both pressure and temperature control
- Normal water conservation control
- Heated floor in lavatory and hall
- Lightweight vanities with under mount sinks
- Double handled vanity faucets standard
- Custom made one-piece lightweight water-tight fiberglass shower enclosure and pan – built in caddy & footrest
- Water pressure and temperature control valve in shower
- Full size stacked ASKO washer and dryer

STATEROOM

- Natural wood veneer cabinetry
- Custom designed ceiling with easily cleaned leatherette, mahogany rails, textured inlay, mirrors and directional roof air venting
- Reading lights above bed
- Maximized LED lighting on dimmers
- Lutron Silent Power Cell Shades which can be operated individually or all together with Savant I-Pad
- Custom King size bed
- Caged design ceiling fan
- Upholstered bed base with storage drawer
- Indirect and accent lighting
- Custom quilted bedding and decorative throw pillows
- Display cabinets on either side of 40" Samsung Smart LED TV
- Digital clock with alarm available on I-Pad
- Pneumatic operated doors with build-in safety disconnect

MILLENNIUM STANDARD SPECIFICATIONS

A/C and Heating Systems

- 4 - 15,000 BTU Reverse Cycle, heat pump, roof mounted, air conditioning systems with Savant controls, I-pad controls and hardwired thermostats
- Air conditioning ducted through ceiling with easy access return points and changeable filters
- 72K BTU Aquahot heater with 1-120 VAC 2000-watt electric element and 1-240 VAC 4500-watt each electric heating element.
 - Aquahot exhausts through roof
 - Engine heating loop system.
- Electric radiant floor heat (under all tile floors throughout coach)
- Aquahot toe board heaters zoned on three thermostats including one in plumbing bay
- 20K BTU multi zone auxiliary heat exchanger ducted to ceiling in two zones activates with Aquahot system
- Electric heat in bathroom (s) toe board with separate thermostat
- Thermostatically controlled 120 VAC ceramic heat in plumbing bay
- Thermostatically controlled 120 VAC ceramic heater in first & second storage bay
- Adjustable directional vents with Millennium's center line design to maximize air flow when slide outs are closed
- Web Remote access to temperature settings with hotspot enabled coaches (Must supply own Air card with Static IP)
- Ceramic film on cockpit windows (33% reduction of heat and 99% reduction in UV rays)

Electrical Systems

- Continuous and uninterrupted marine grade tin plated stranded wiring
- 24 V electrical charging system via 4 150-amp alternators
- Chassis alternator emergency bypass capabilities
- Lutron HomeWorks coach automation control system with Savant interface and remote diagnostic capabilities
- iPad in dash, iPad in plumbing bay and iPad by buddy seat
- iPad controller with docking station in Salon & Stateroom
- Marine grade electrical breaker panels
- 20 KW Powertech ultimate turbo generator with gauged airbag suspension
 - Exclusive Millennium generator radiator roof mounted system

- Generator exhausts through roof
- Auto start feature for generator
- Unique battery boost circuitry
- Ultra-quiet generator compartment marine grade sound dampening insulation system & secondary floor isolators
- 100-amp automatic transfer switch
- 4 – 3,500-Watt Outback 24 V pure sine wave inverters
 - 4 inverter disconnects with marine grade switches
 - 2 manual inverter by-pass switches
- 8 – 4D AGM deep cycle batteries
- Generator starting circuitry utilizes either chassis or house batteries
- 100' shore power cord on Glendenning electric reel with remote control
- 15 amp to 30-amp shore cord adapter and a 30 amp to 50-amp shore cord adapter
- Dedicated hardwired Lutron light switch panels in every room
- Cabinet LED toe kick lighting throughout coach
- Dimmable accent lighting around ceiling hardwood trim
- LED accent lighting around window frames
- Dimmable LED ceiling lights
- 2 station intercom system with remote control exterior camera and monitor in stateroom
- LED lights inside all interior cabinets

Audio Visual Systems

- 55" Samsung Smart LED TV on a marine grade TV lift system (Salon)
 1. Marantz Surround Sound Receiver
 2. Full Range 3 Channel Sound Bar
 3. 3.5 "rear speakers
 4. Evolution 8" Powered Subwoofer
 5. Plex Media Server with 3 terabyte Time Capsule (For Movie Storage)
- 40" Samsung Smart LED TV (Stateroom)
 1. 3.1 Channel Surround Sound System with a Full Range 3 Channel Sound Bar
- 55" Samsung Smart LED TV (Entertainment bay) 1.3.1 Channel Surround Sound System with a Full Range 3 Channel Sound Bar
- Configurable Savant 8x8 HDMI Switcher with an 8x8 Audio Switch
- Blue Ray player
- Savant Control System with iPad integration controlling:
 1. Lighting
 2. Awnings
 3. Slide Controls (except Valid)
 4. Mechanical Systems
 5. Air Conditioning and Heating
 6. Shades
 7. Security Cameras and DVR
 8. Audio/Video Functions
 9. Shore / Generator input Status
 10. Awning Window Controls
- 40 Channel Uniden CB Radio with weather band and remote external speaker
- Winegard Dome In-Motion Satellite System
- Winegard High-Definition Satellite Antenna System for HD programming while parked – auto stow feature when coach is started
- 2 HD DVR Satellite Receivers
- Stationary Fully Digital High-Definition Off-Air marine grade Antenna
- Ground Loop noise isolation on cable TV input
- HDMI wiring to all smart TVs
- Easy to use and understand graphics on iPad controls
- Apple Mac-minicomputer with wireless keyboard and mouse. Available on all TVs
- Apple TV available on all TVs

- 4 Security Cameras (upgradeable to 9 cameras) with 2 TB DVR (upgradeable to 8 TB). Available on all TVs and I-Pads
- External satellite antenna connection and switching
- Integrated Bluetooth module for whole house listening capabilities
- 360° view camera system

Plumbing System

- Polished food grade stainless steel freshwater tank
- Polyurethane black water tank
- Polyurethane gray water tank
- Machined aluminum laminate with stain free finish
- Hot and cold-water faucet in plumbing compartment
- Water inlet connections for holding tanks clean out
- Manablock plumbing system for constant pressure with individual shut off valves on all fixtures
- Stainless steel hardware
- Auto freshwater fill system
- Built-in 35' freshwater hose on electric reel for freshwater fill system
- Fresh water inlets on both sides of the plumbing bay
- Electric/mechanical 3" dump valves
- 110 VAC Mach 5 multi-stage main water pump
- 12V auxiliary water pump system
- Pressure tank for more efficient water pump operation
- Adjustable city water regulator 80 PSI
- 10-micron whole house filter
- 5-micron GE drinking water filter system
- Fresh tank drain valve
- 1450 PSI - 110 VAC pressure washer with hot & cold-water supply – 75ft 3000 PSI hose on electric reel
- Built-in water deionizer for spot free rinse after washing
- Gravity fill inlet on passenger side

Pilot and Co-Pilot seating area

- Step well cover with control switch by the co-pilot seat
- Custom durable easy clean mats on entry steps
- Handrails on both sides of entry
- Custom made one-piece fiberglass; ergonomic dash upholstered using double baseball stitching
- Electric privacy screen and sunshades with controls by both pilot and co-pilot
- Smart Wheel
- Wood veneer dash panels
- ISRI air ride pilot seat upholstered in-house with decorator inserts. Air adjustable base, massage, heating and a 3-point seat belt
- Cup holders and storage compartments by both pilot and co-pilot seating
- 28" co-pilot seat upholstered in-house with decorator inserts and six-way adjustable electric base, massage, heating, a two-way footrest and a 3-point seat belt
- Pilot and co-pilot map lights
- Ergonomically located controls and gauges on driver's dash
- LED shore power indicators at dash for quick visual status
- Custom clock & outside temperature gauge in helm area
- Hard wired Savant touchpad interfaced with high resolution backup and side view cameras. Easy touch screen pan and tilt and side cameras turn signal activated
- 360-degree camera system displayed on dedicated center post monitor
- Master lighting switch control inside door
- Keyless touchpad entry system with key fob and integrated alarm – ability to pop entry door open with the push of a button for ease of access
- Open shoe storage in stepwell

